



Technical information

EN

OEnovia TD 200 / 250 / 200 H / 250 H*

TWH 200 E / 250 E / 200 EH / 250 EH PRO*

Heat pump water heater

Troubleshooting: H06.44 and E06.50

JS

N° ITOE0261-en

10/04/2024

Checks in case of recurring faults **H06.44** and **E06.50**:

1. Check that the reassembly is correct

A : Cables in place and secured with cable ties

B : No gap between heater and intermediate cover after reassembly

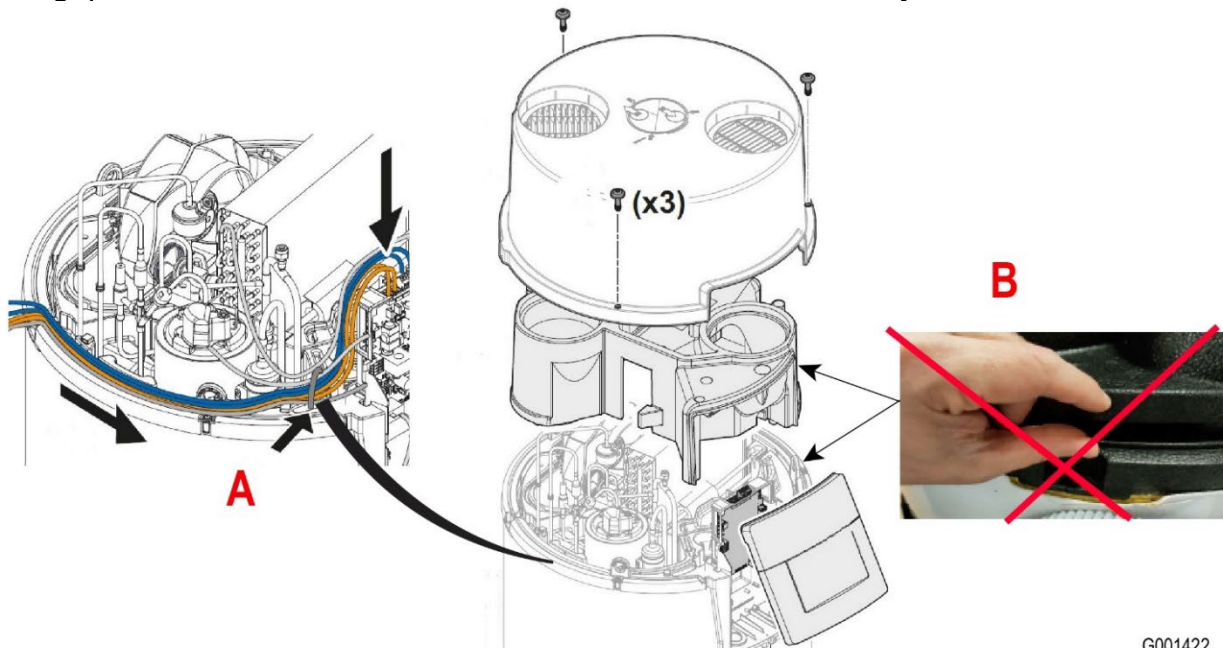

G001422

2. Check the air duct connections

2.1 Comply with authorised connections: non-ducted / ducted / single-ducted

- Without ducts (and without accessory ...):

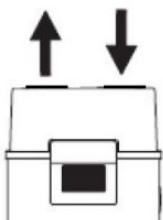

Warning : Any addition of accessory(ies) to the air inlet/outlet (elbow, duct...) will be considered as a connection with duct.

*Models depending on the country

▪ **Ducted connections:**

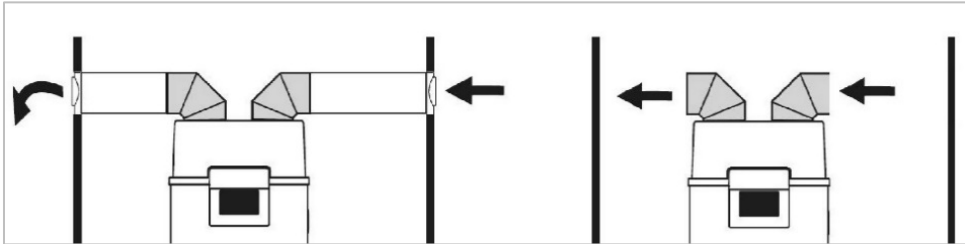

▪ **Single-duct connections:**

Warning: the only permitted single duct connections are:

- Air outlet **with** air duct (or elbow,...)
- Air inlet **without** air duct (nor elbow)

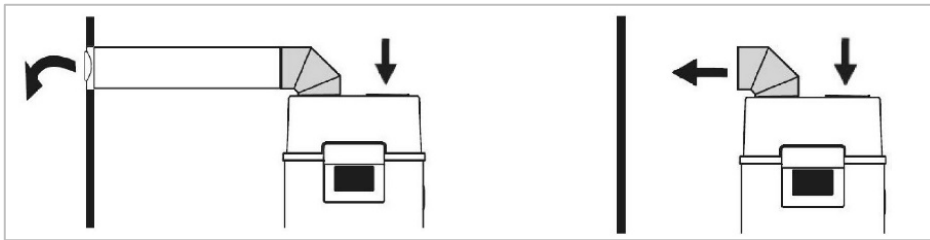

2.2 For connections without ducts, nor accessories:

- Leave the air inlet grids and the directional air outlet grid in place..
- Align the air outlet grid (5 possible positions) so that there is no air recirculation between the air outlet and air inlet.

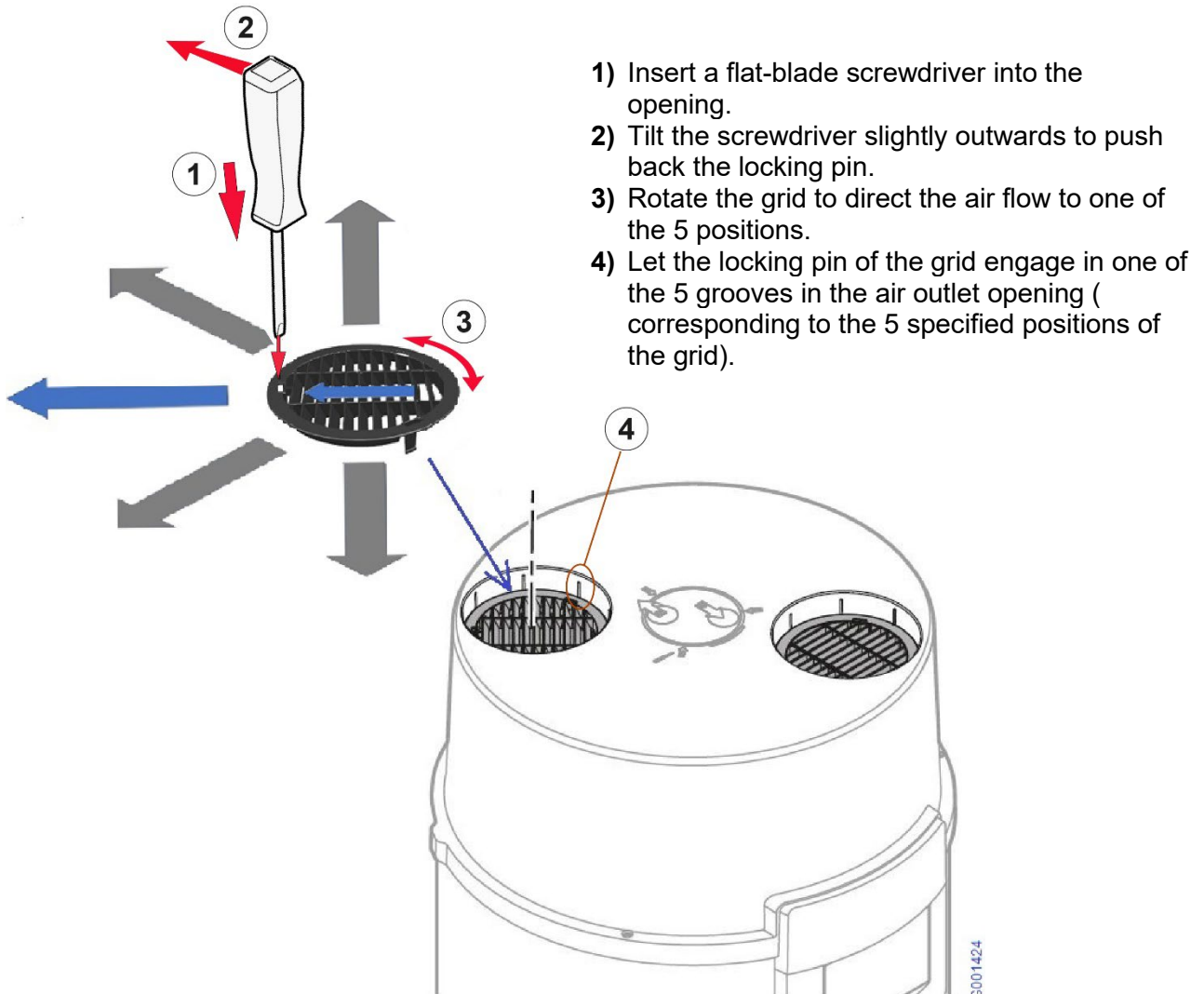

G001424

2.3 For connection with ducts or single duct:

- Soft ducts must be avoided
- Use rigid, smooth ducts (semi-rigid ducts are tolerated)
- Observe the maximum permissible lengths L1 (≤ 10 M) and L2 (≤ 10 M).
The installation of accessory(ies) leads to an additional pressure loss: When calculating the duct length, take into account the equivalent lengths of the installed accessories (elbows, or other accessories...).
- **See Manual** for the equivalent duct lengths.
- **Wall grid:** it is strongly recommended to use the **Oertli** very low pressure loss grids.
- **Connction with ducts:**
 - Remove the air inlet and air outlet grids (see illustration below).
 - For galvanised ducts: Insert **seals** (option HK437): Direct **lips downwards**.

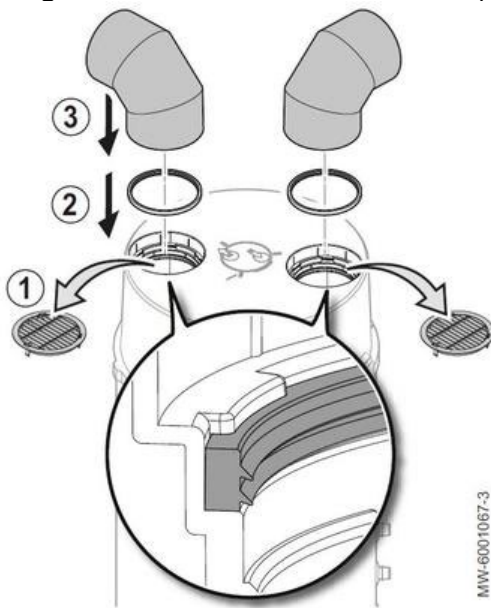

▪ **Single-duct connection:**

- Only remove the **grid on the air outlet side (1)**
- For a galvanised duct: Insert a **seal** (option HK437): Direct **lips downwards**.
- Leave the grid in place on the **air inlet** side: it prevents foreign objects from entering and directs the air flow.

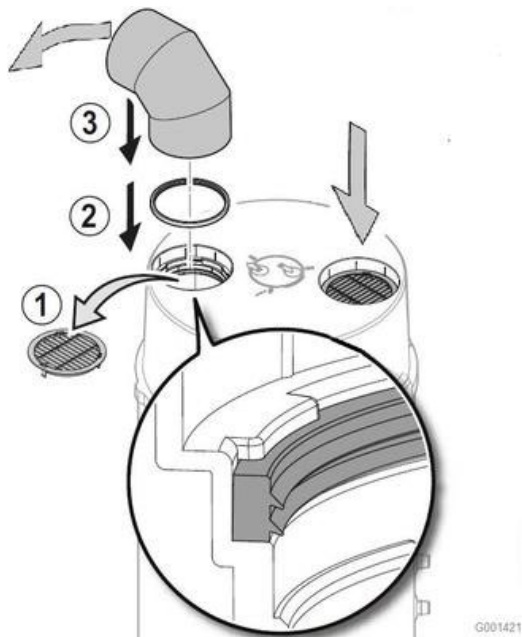



3. Check correct settings (CN1, HP028, HP081)

Parameter **CN1** is defined according to:

- - the software version of the **CU-HW-01** electronic board
- - the type of connection: ducted (and single-ducted) or non-ducted.
(The **single-ducted** connection is considered as a ducted connection for parameter **CN1**).

3.1 Check the Softwareversion of CU-HW-01 main PCB

- a) Press the  button
- b) Select symbol  : **Version information.**
- c) The software version is displayed:

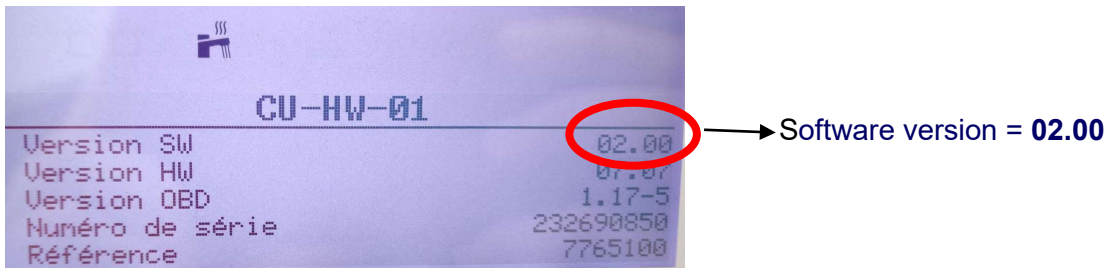

3.2 Check / set the parameters according to the software version and the connection type:

- **Connection without ducts and accessories:**

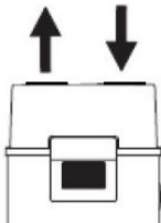

Warning : Any addition of accessory(ies) to the air inlet/outlet (elbow, duct...) will be considered as a connection with duct.

Apliance type (Models depending on the country)	Air duct connection	CN1 Version CU-HW-01: 1.01 or below	CN1 Version CU-HW-01: 1.02 or above	HP028* (Via surch function Q)	HP081 (Via surch function Q)
-OEnovia TD 200 -TWH 200 E PRO (Electric backup)	Without ducts	1	1	Ambient air	-8
-OEnovia TD 250 -TWH 200 E PRO (Electric backup)	Without ducts	3	5	Ambient air	-8
-OEnovia TD 200 H -TWH 200 EH PRO (Hydraulic backup)	Without ducts	2	2	Ambient air	-8
-OEnovia TD 250 H -TWH 250 EH PRO (Hydraulic backup)	Without ducts	4	6	Ambient air	-8

*Parameter HP028 (Fan speed) for CU-HW-01 versions 1.01 or below: Setting HP028= Ambient air= Speed 2.

▪ **Connection with ducts or single duct:**

• **With ducts**

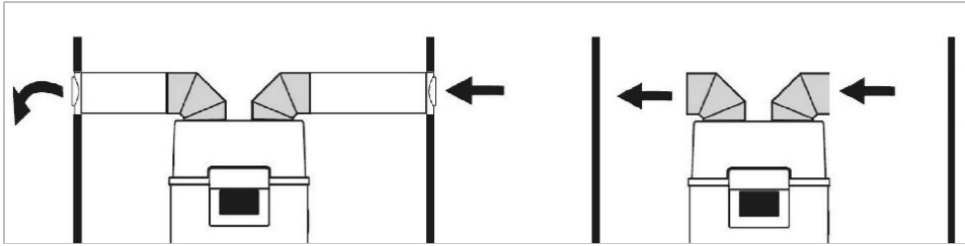

• **With single-duct:**

Warning: the only permitted single duct connection is:

- Air outlet **with** air duct (or elbow,...)
- Air inlet **without** air duct (nor elbow)

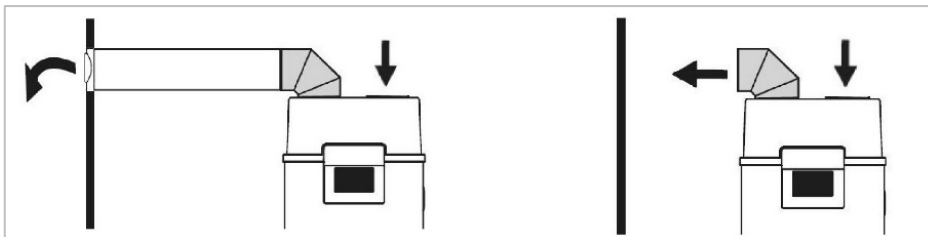

Apliance type (Models depending on the country)	Air duct connection	CN1 Version CU-HW-01: 1.01 or below	CN1 Version CU-HW-01: 1.02 or above	HP028* (Via surch function Q)	HP081 (Via surch function Q)
-OEnovia TD 200 -TWH 200 E PRO (Electric backup)	With ducts or Single duct	1	3	Air supply duct	-5
-OEnovia TD 250 -TWH 200 E PRO (Electric backup)	With ducts or Single duct	3	7	Air supply duct	-5
-OEnovia TD 200 H -TWH 200 EH PRO (Hydraulic backup)	With ducts or Single duct	2	4	Air supply duct	-5
-OEnovia TD 250 H -TWH 250 EH PRO (Hydraulic backup)	With ducts or Single duct	4	8	Air supply duct	-5

*Parameter HP028 (Fan speed) for CU-HW-01 versions 1.01 or below: Setting HP028= Air supply duct= Speed 1.

i If the faults persists: Please contact us.